



The Sliding door pocket system  
that you can install  
**BY YOURSELF!**





# INDEX

---

4	SIMPLICITY AND INNOVATION
4	EASY INSTALLATION
7	ONE
11	GIANT ONE
15	TWIN ONE
19	CRISTAL KIT ONE
23	SMARTY
27	FINE
30	BLEND



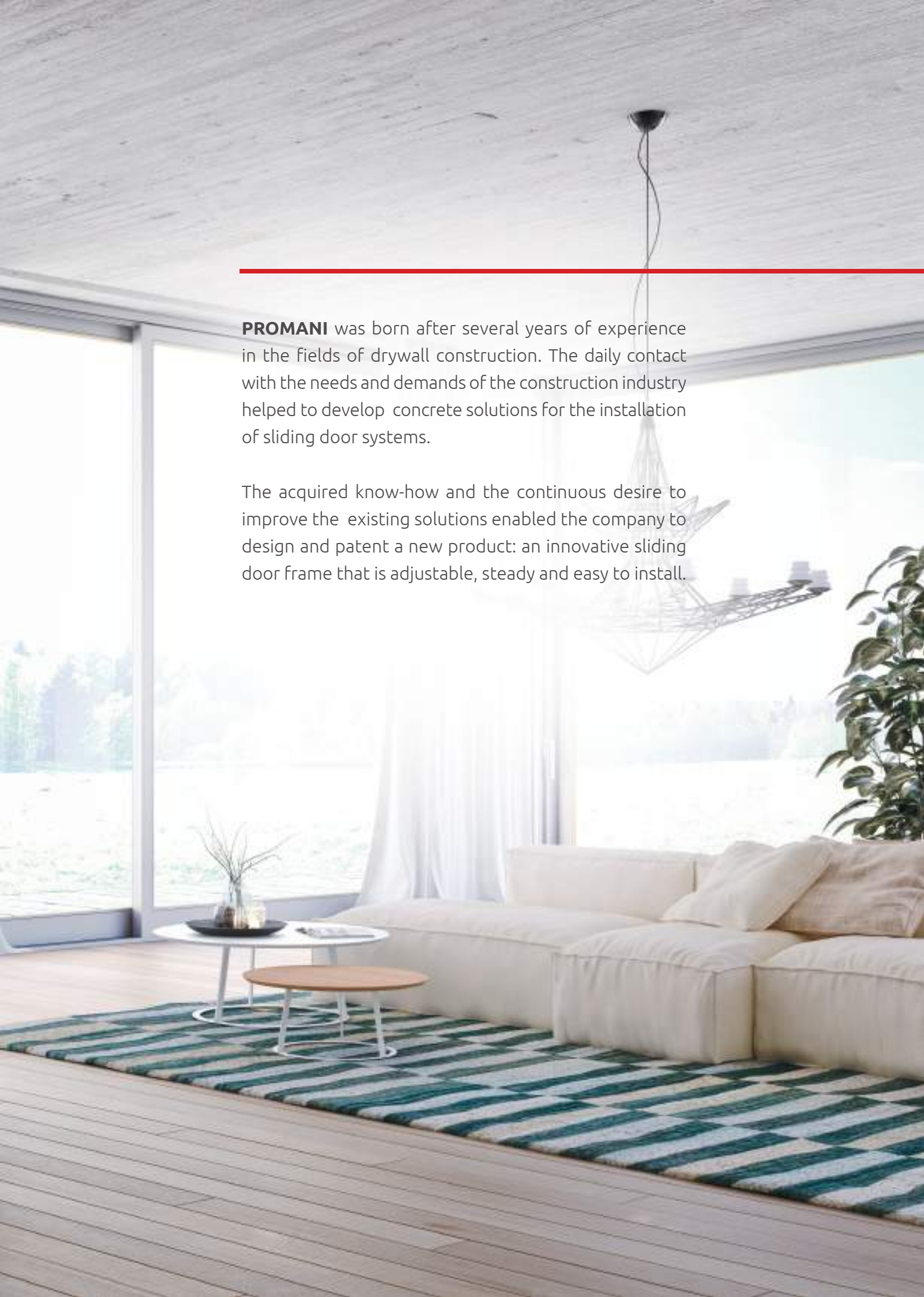

**PROMANI** was born after several years of experience in the fields of drywall construction. The daily contact with the needs and demands of the construction industry helped to develop concrete solutions for the installation of sliding door systems.

The acquired know-how and the continuous desire to improve the existing solutions enabled the company to design and patent a new product: an innovative sliding door frame that is adjustable, steady and easy to install.



# SIMPLICITY AND INNOVATION

Why is Promani's sliding pocket door a truly innovative product?  
It's so easy that you can install it by yourself!

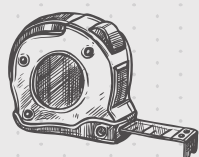

Define height and width of the sliding door and adapt our frame to the size of the door you need.

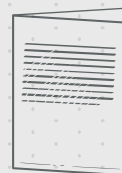

Following the instruction manual arrange all the components of the frame in the correct order of installation.

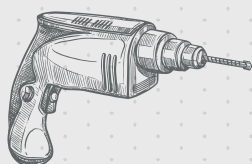

Proceed with on-site assembly and install the pocket in place.



Finished! Now you only need to install the door of your sliding system!

The details and the applied technical solutions make the difference in terms of convenience of use and performance, during the installation of the sliding door.

## EASY INSTALLATION

Thanks to the Promani Kit, the installation steps of the sliding door are very fast and intuitive. A solution that is suitable for DIY lovers as well as for a professional audience!

### SMALL SIZE, MAXIMUM RESULTS

Thanks to a system that optimizes storage, up to 8 standard sizes can be made with just one **product**.



### ONE POCKET, MANY DIMENSIONS

Promani frames simplify the standard procedure of installing a sliding door pocket system. In fact, during the installation phase, our kits can be **adapted** directly to the final size of the sliding door.



### STANDARD DOUBLE-SIDED DAMPING SYSTEM INCLUDED

Unlike other products already on the market, Promani offers a two-way damping system of the sliding door always included inside the kit **as standard equipment**. According to the company philosophy, it is important to offer our customers a complete product for the best user experience.



### EXTRACTABLE TRACK

The track has been especially designed to be **easily removed** even when the sliding door system is fully installed. In this way, it is possible to add accessories even if the product is already in place, without damaging the wall finishings.



### DRYWALL U PROFILES

The U shape on the outer perimeter of the frame allows the direct installation of the C profiles to complete the plasterboard structure of the wall. This solution makes it possible to **improve and to accelerate the installation** process of the pocket without using additional U profiles.



### SPACER PROFILE

The spacer profile included in the Promani Door Frame Kit allows a **perfectly** aligned installation to the plasterboard structure, avoiding accidental mistakes that sometimes happens in drywall construction.







# ONE

---

Sliding pocket door  
**ENTIRELY MADE OF  
ZINC-COATED STEEL,**  
with wooden doorposts

ONE is the pocket system for sliding doors that unifies tradition and innovation. The frame is completely made of **zinc-coated steel** and has to be completed with jambs and architraves.

Thanks to its characteristics, the sliding door frame ONE **fits into any door measure** and represents a practical solution. It guarantees a comfortable daily use of sliding doors, creating a modern and clean style in internal spaces.



## TECHNICAL CHARACTERISTICS

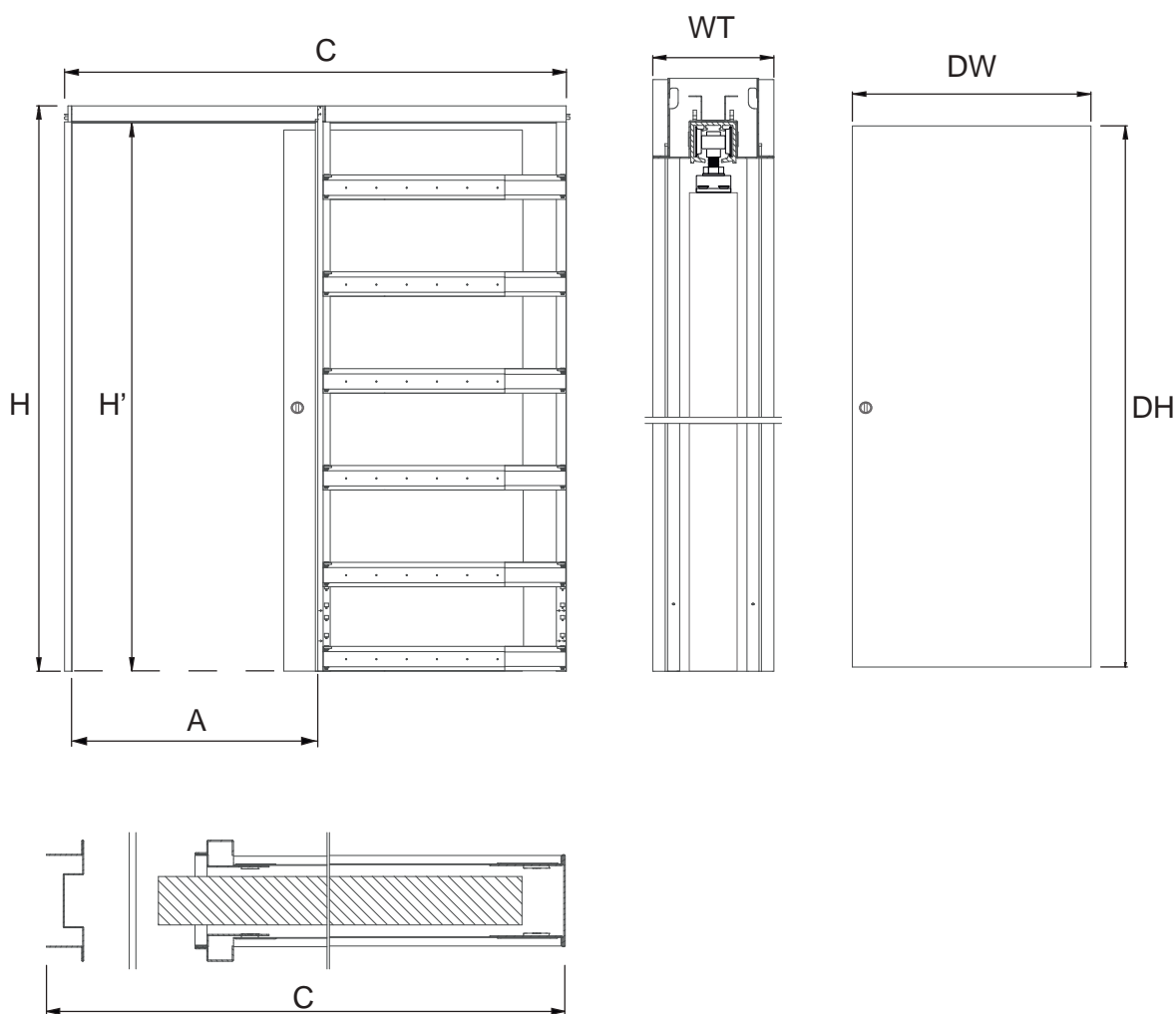

\* maximum thickness of wooden door panel: 42 mm

- Easy removable track
- Standard double-sided damping system included
- The backside position of the damping system can be adjusted at any moment
- The upper profile can be used as a track for the drywall structure
- The upper track has a specific metallic element that allows the sliding of C profiles of the drywall structure without any problems
- The upper profile has different marks in order to change the width of the door depending on the measure you need

### UK610-838ONE DATA SHEET

<b>DW x DH</b> Door dimensions	<b>C x H</b> Frame dimensions	<b>A x H'</b> Opening of the doorway	<b>WT</b> Wall thickness
610 x 1981 mm	1418 x 2086 mm	640 x 2016 mm	100/125 mm
610 x 2040 mm	1418 x 2145 mm	640 x 2075 mm	100/125 mm
686 x 1981 mm	1570 x 2086 mm	716 x 2016 mm	100/125 mm
686 x 2040 mm	1570 x 2145 mm	716 x 2075 mm	100/125 mm
762 x 1981 mm	1722 x 2086 mm	792 x 2016 mm	100/125 mm
762 x 2040 mm	1722 x 2145 mm	792 x 2075 mm	100/125 mm
838 x 1981 mm	1874 x 2086 mm	868 x 2016 mm	100/125 mm
838 x 2040 mm	1874 x 2145 mm	868 x 2075 mm	100/125 mm

### UK914ONE DATA SHEET

<b>DW x DH</b> Door dimensions	<b>C x H</b> Frame dimensions	<b>A x H'</b> Opening of the doorway	<b>WT</b> Wall thickness
914 x 1981 mm	2026 x 2086 mm	944 x 2016 mm	100/125 mm
914 x 2040 mm	2026 x 2145 mm	944 x 2075 mm	100/125 mm

- The vertical elements have different marks in order to change the height of the door depending on the measure you need
- The crossbeam are adjustable to the width of the door panel you need
- The hooking of the crossbeams is facilitated
- The 100 cm height from the floor is marked
- The alignment of the frame takes place through a spacer profile
- The door-guide allows you to centre the door panel
- The anterior profile is a perfect fit for the vertical studs of the plasterboard structure, allowing a perfect alignment to the wall



# GIANT ONE

---

## Accessory OUT OF STANDARD HEIGHT

GIANT is the accessory that allows each ONE pocket to reach heights up to 2.70 meters.

An innovative solution for sliding door systems that reduces installation time for doors with non-standard height. A simple transformation from ONE to a XXL frame in height.





# TECHNICAL CHARACTERISTICS

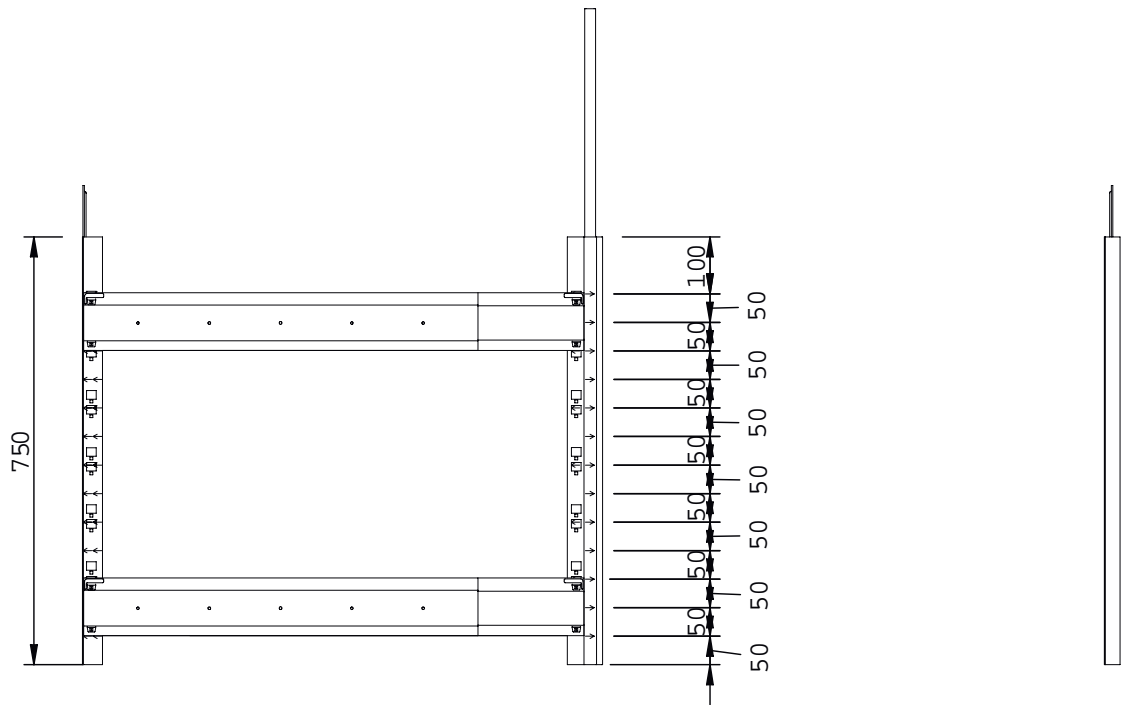

- Maximum height of door panel reachable: 2700 mm
- Height increase with step 5 cm
- Creation of a counter frame with “oversized” height in a short time
- Small packaging size to optimize storage: 120 x 14 x 9 cm

## GIANT ONE DATA SHEET

<b>DH</b> Door dimension	<b>H</b> Frame dimension	<b>H'</b> Width of the doorway	<b>WT</b> Wall thickness
2140 mm	2245 mm	2175 mm	100/125 mm
2190 mm	2295 mm	2225 mm	100/125 mm
2240 mm	2345 mm	2275 mm	100/125 mm
2290 mm	2395 mm	2325 mm	100/125 mm
2340 mm	2445 mm	2375 mm	100/125 mm
2390 mm	2495 mm	2425 mm	100/125 mm
2440 mm	2545 mm	2475 mm	100/125 mm
2490 mm	2595 mm	2525 mm	100/125 mm
2540 mm	2645 mm	2575 mm	100/125 mm
2590 mm	2695 mm	2625 mm	100/125 mm
2640 mm	2745 mm	2675 mm	100/125 mm
2690 mm	2795 mm	2725 mm	100/125 mm

- Pre-drilled elongation profiles to facilitate installation
- Pre-traced elongation profiles to facilitate the identification of the correct height
- Additional horizontal bars included in the package
- Guaranteed stability



# TWIN ONE

---

## Accessory **DOUBLE DOOR**

Thanks to TWIN you can join 2 ONE pockets and get a double concealed sliding door system.

Using a simple template and specific pins, the coupling of two pockets is easy and error-free. For greater openings, with very short assembly times.



## TECHNICAL CHARACTERISTICS

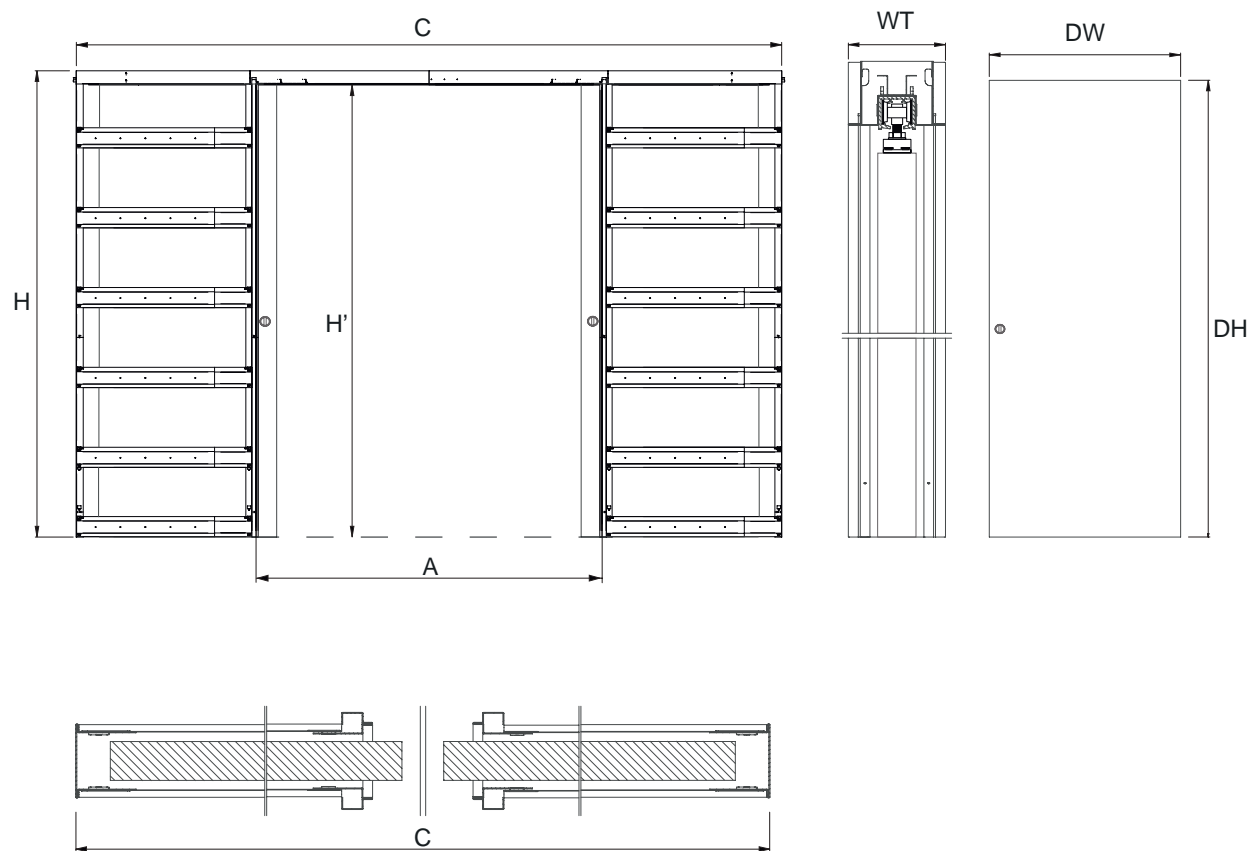

- Creation of large doorways up to over 2200 mm
- Use of door panels with standard widths
- No compensation intervention on the jambs and architraves
- Creation of a double door counterframe in a short time



### TWIN ONE DATA SHEET

<b>DW x DH</b> Door dimension	<b>C x H</b> Frame dimension	<b>C' x H'</b> Width of the doorway	<b>WT</b> Wall thickness
610+610 x 1981 mm	2733 x 2068 mm	1230 x 2016 mm	100/125 mm
610+610 x 2040 mm	2733 x 2145 mm	1230 x 2075 mm	100/125 mm
686+686 x 1981 mm	3037 x 2086 mm	1382 x 2016 mm	100/125 mm
686+686 x 2040 mm	3037 x 2145 mm	1382 x 2075 mm	100/125 mm
762+762 x 1981 mm	3341 x 2086 mm	1534 x 2016 mm	100/125 mm
762+762 x 2040 mm	3341 x 2145 mm	1534 x 2075 mm	100/125 mm
838+838 x 1981 mm	3645 x 2086 mm	1686 x 2016 mm	100/125 mm
838+838 x 2040 mm	3645 x 2145 mm	1686 x 2075 mm	100/125 mm
914+914 x 1981 mm	3949 x 2086 mm	1838 x 2016 mm	100/125 mm
914+914 x 2040 mm	3949 x 2145 mm	1838 x 2075 mm	100/125 mm
815+815 x 2110 mm	3343 x 2215 mm	1640 x 2145 mm	100/125 mm

- Small packaging size to optimize storage: 34 x 13 x 9 cm
- Steel templates to simplify the cutting of the upper profile
- Reinforced pairing joints for the upper profile
- Guaranteed stability



# CRISTAL KIT ONE

---

## Accessory **FOR COMPLETELY GLASS DOORS**

With CRISTAL KIT any glass door panel can be inserted in ONE counterframes, thanks to the solid aluminum pliers.

The particularly practical feature provides that the measurement of the height of the glass doors does not suffer differences from the wooden doors installed in the same subframe, avoiding complex calculations potentially subject to mistakes.



# TECHNICAL CHARACTERISTICS

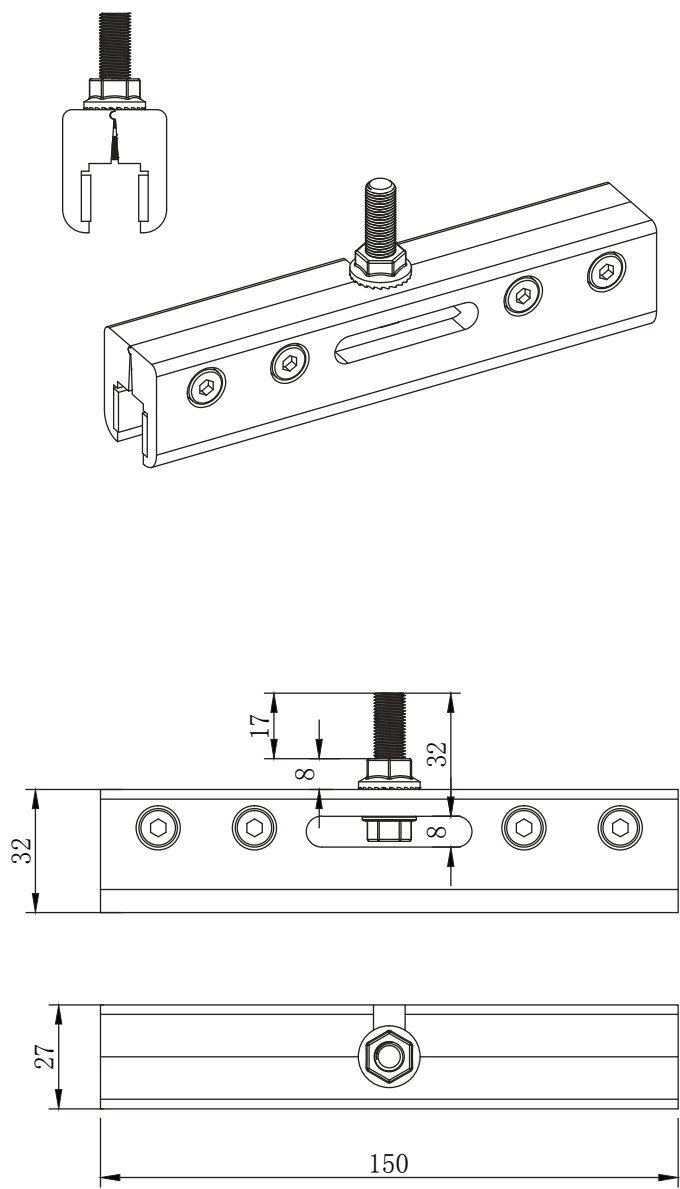

### CRISTAL KIT ONE DATA SHEET

<b>DW x DH</b> Door dimension	<b>C x H</b> Frame dimension	<b>A x H'</b> Opening of the doorway	<b>WT</b> Wall thickness
610 x 1981 mm	1418 x 2086 mm	640 x 2016 mm	100/125 mm
610 x 2040 mm	1418 x 2145 mm	640 x 2075 mm	100/125 mm
686 x 1981 mm	1570 x 2086 mm	716 x 2016 mm	100/125 mm
686 x 2040 mm	1570 x 2145 mm	716 x 2075 mm	100/125 mm
762 x 1981 mm	1722 x 2086 mm	792 x 2016 mm	100/125 mm
762 x 2040 mm	1722 x 2145 mm	792 x 2075 mm	100/125 mm
838 x 1981 mm	1874 x 2086 mm	868 x 2016 mm	100/125 mm
838 x 2040 mm	1874 x 2145 mm	868 x 2075 mm	100/125 mm
914 x 1981 mm	2026 x 2086 mm	944 x 2016 mm	100/125 mm
914 x 2040 mm	2026 x 2145 mm	944 x 2075 mm	100/125 mm

- Aluminum clamps for doors up to 100 kg
- Use of door panels with standard heights





# SMARTY

---

Sliding pocket door  
**ENTIRELY MADE  
OF ALUMINIUM,**  
with wooden doorposts

SMARTY is the **pocket for sliding doors** that offers ease of installation and comfort in your daily use.

The frame is completely made of aluminium and has to be completed with jambs and architraves. Our frames can be matched with different kind of doors and our kit for glass doors.

Aluminium frames are specifically made for the installation of sliding doors in locations with **high levels of humidity** or salinity and in public or sanitary environments thanks to their ability to resist corrosion.



## TECHNICAL CHARACTERISTICS

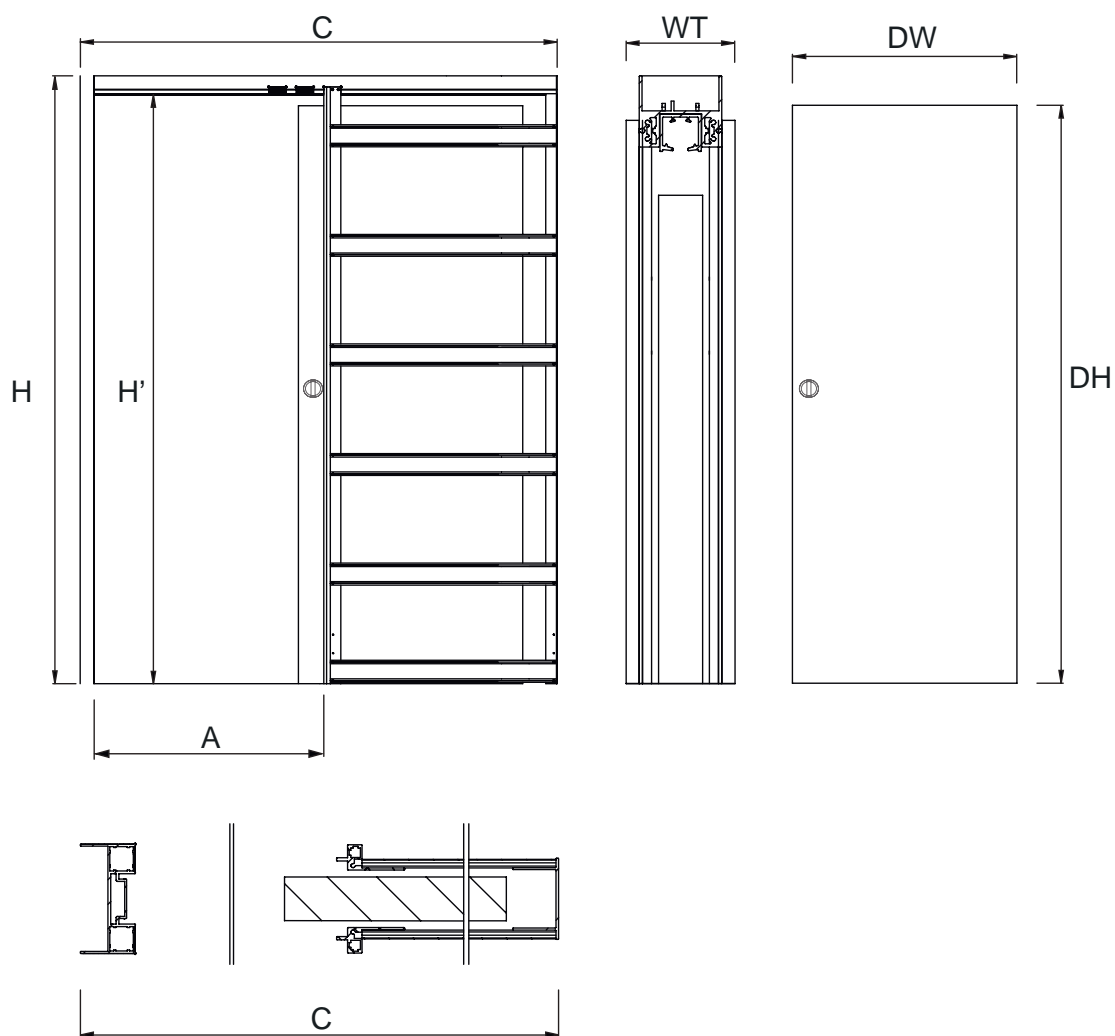

\* maximum thickness of wooden door panel: 38 mm

- It is a C5 certified anti-corrosion product
- Easy removable track
- Standard double-sided damping system included
- The backside position of the damping system can be moved in any moment
- The upper profile can be used as a track for the drywall structure
- The upper profile has different marks in order to change the width of the door depending on the measure you need

### UK610-838SMA DATA SHEET

<b>DW x DH</b> Door dimension	<b>C x H</b> Frame dimension	<b>A x H'</b> Opening of the doorway	<b>WT</b> Wall thickness
610 x 1981 mm	1322,5 x 2090 mm	640 x 2021 mm	100/125 mm
610 x 2040 mm	1322,5 x 2149 mm	640 x 2080 mm	100/125 mm
686 x 1981 mm	1474,5 x 2090 mm	716 x 2021 mm	100/125 mm
686 x 2040 mm	1474,5 x 2149 mm	716 x 2080 mm	100/125 mm
762 x 1981 mm	1626,5 x 2090 mm	792 x 2021 mm	100/125 mm
762 x 2040 mm	1626,5 x 2149 mm	792 x 2080 mm	100/125 mm
838 x 1981 mm	1778,5 x 2090 mm	868 x 2021 mm	100/125 mm
838 x 2040 mm	1778,5 x 2149 mm	868 x 2080 mm	100/125 mm

### UK914SMA DATA SHEET

<b>DW x DH</b> Door dimension	<b>C x H</b> Frame dimension	<b>A x H'</b> Opening of the doorway	<b>WT</b> Wall thickness
914 x 1981 mm	1930,5 x 2090 mm	944 x 2021 mm	100/125 mm
914 x 2040 mm	1930,5 x 2149 mm	944 x 2080 mm	100/125 mm

- Vertical elements have different marks in order to change the height of the door depending on the measure you need
- The 100 cm height from the floor is marked
- The alignment of the frame takes place through a spacer profile
- The door-guide allows you to centre the door panel
- The anterior profile is a perfect fit for the vertical studs of the plasterboard structure, allowing a perfect alignment to the wall





# FINE

---

Flush sliding pocket door  
**ENTIRELY MADE  
OF ALUMINIUM,**  
without wooden doorposts

FINE is the flush pocket system for sliding doors designed to improve any living or professional environment with elegance.

Its finish **without jambs and architraves** gives the wall in which the sliding door is installed a minimal look, perfectly integrating with the surrounding space.

This frame is **entirely made in aluminium** making it the most suitable solution for places with high humidity or salinity and in public or sanitary environments.



## TECHNICAL CHARACTERISTICS

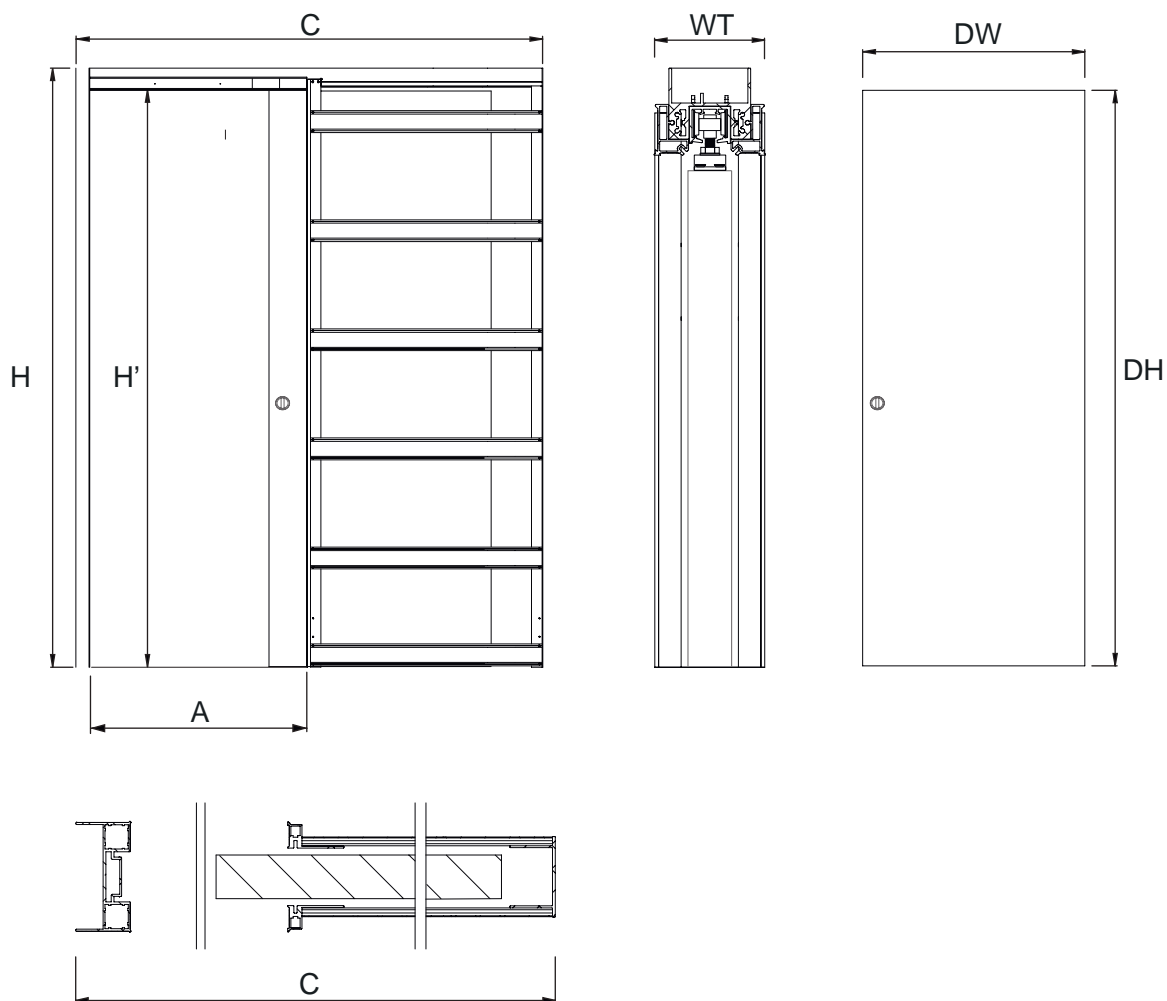

\* maximum thickness of wooden door panel: 38 mm

- It is a C5 certified anti-corrosion product
- Removable track
- Standard double-sided damping system included
- The backside position of the damping system can be moved in any moment
- The upper profile can be used as a track for the drywall structure
- The upper profile has different marks in order to change the width of the door depending on the measure you need
- The exterior aspect of the door is without any architraves

### UK610-838FIN DATA SHEET

<b>DW x DH</b> Door dimension	<b>C x H</b> Frame dimension	<b>A x H'</b> Opening of the doorway	<b>WT</b> Wall thickness
610 x 1981 mm	1302,5 x 2067 mm	592 x 1987 mm	100/125 mm
610 x 2040 mm	1302,5 x 2126 mm	592 x 2046 mm	100/125 mm
686 x 1981 mm	1454,5 x 2067 mm	668 x 1987 mm	100/125 mm
686 x 2040 mm	1454,5 x 2126 mm	668 x 2046 mm	100/125 mm
762 x 1981 mm	1606,5 x 2067 mm	744 x 1987 mm	100/125 mm
762 x 2040 mm	1606,5 x 2126 mm	744 x 2046 mm	100/125 mm
838 x 1981 mm	1758,5 x 2067 mm	820 x 1987 mm	100/125 mm
838 x 2040 mm	1758,5 x 2126 mm	820 x 2046 mm	100/125 mm

### UK914FIN DATA SHEET

<b>DW x DH</b> Door dimension	<b>C x H</b> Frame dimension	<b>A x H'</b> Opening of the doorway	<b>WT</b> Wall thickness
914 x 1981 mm	1912,5 x 2096 mm	897 x 2016 mm	100/125 mm
914 x 2040 mm	1912,5 x 2196 mm	897 x 2116 mm	100/125 mm

- Vertical elements have different marks in order to change the height of the door depending on the measure you need
- The 100 cm height from the floor is marked
- The alignment of the frame takes place through a spacer profile
- The door-guide allows you to centre the door panel
- The anterior profile is a perfect fit for the vertical studs of the plasterboard structure, allowing a perfect alignment to the wall

# BLEND

---

Flush flexible  
**LED PROFILE**



BLEND is a flexible aluminium profile with LED strip that can be adapted to every mould, both for walls and ceilings, even to create curved shapes. It's flexible and adjustable so that it can become a design element or it can be hung up as an hanging chandelier.

BLEND, once installed, it perfectly integrates into the plasterboard with an aesthetically pleasing and minimal result, according to the modern styles.

The product is completed with orthogonal joint for the connection wall-ceiling, linear and angular joints that allow the connection among profiles.

## TECHNICAL CHARACTERISTICS

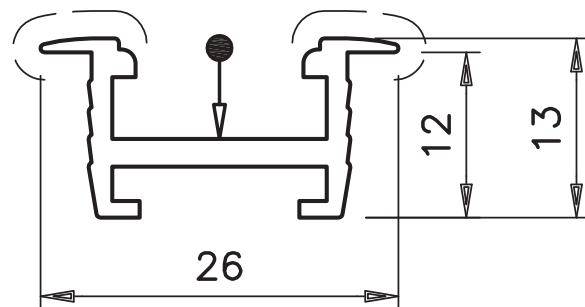

### BLEND DATA SHEET

	DESCRIPTION	DIMENSION
Aluminium LED profile BLEND	Flexible aluminium profile where you can insert LED stripes	2 metres long
Opal Cover diffuser	Opal cover of the LED stripe	2 metres long
Angular joint	Flat Angular joint that allows the connection between 2 different bars creating a flat corner	5x5 cm
Orthogonal joint	Orthogonal joint that allows the connection between 2 different bars at 90° for connection wall-ceiling	5x5 cm
Linear joint	Linear joint that allows the connection of 2 different bars	10 cm
Suspension accessory	Accessory that allows you to hang the profile as an hanging chandelier	5 cm
End cap	Accessory that closes the profiles sideways	Same dimension of the aluminium profiles
Cross joint	Accessory that allows the cross connection of four different profiles	11x11 cm

END CAP - 1/F

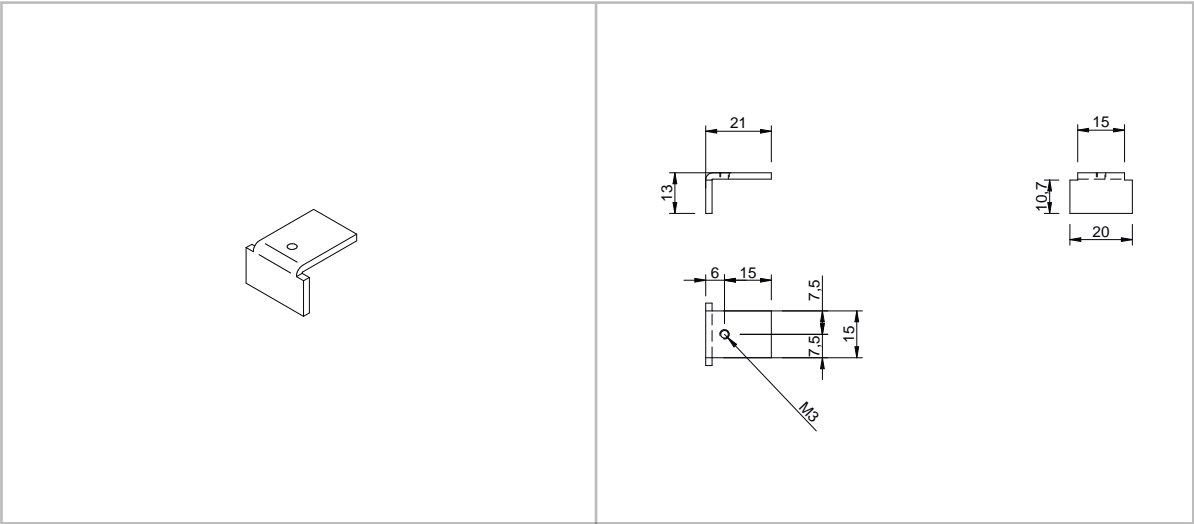

OTHOGONAL JOINT - 2/F

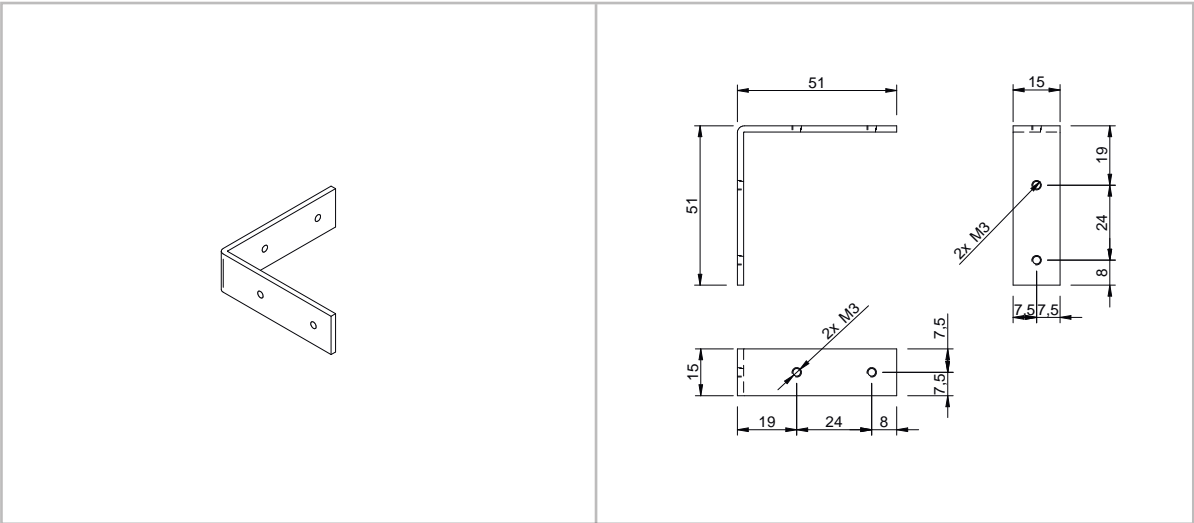

CROSS JOINT - 3/F

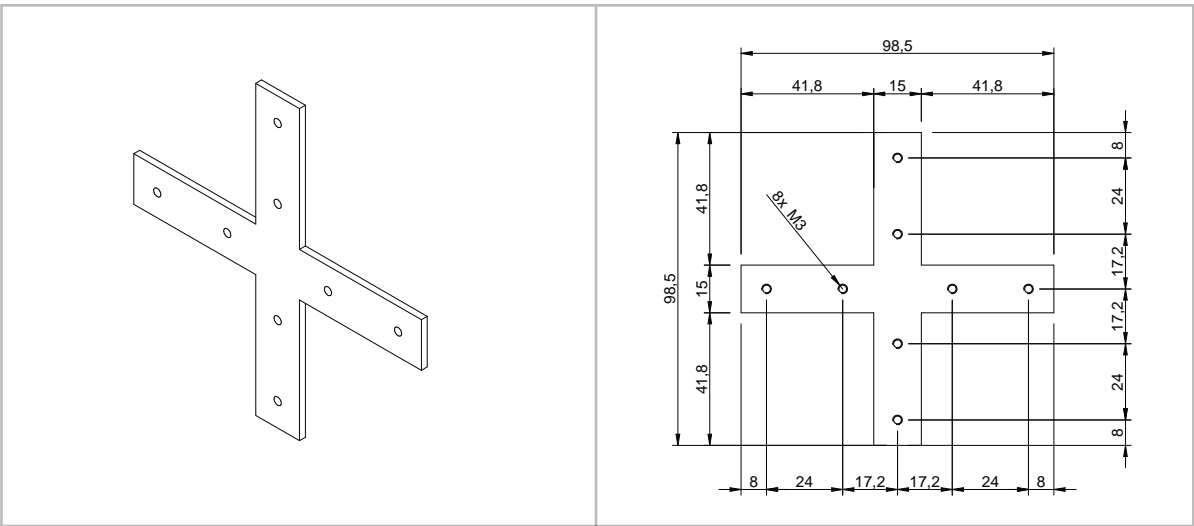

ANGULAR JOINT - 4/F

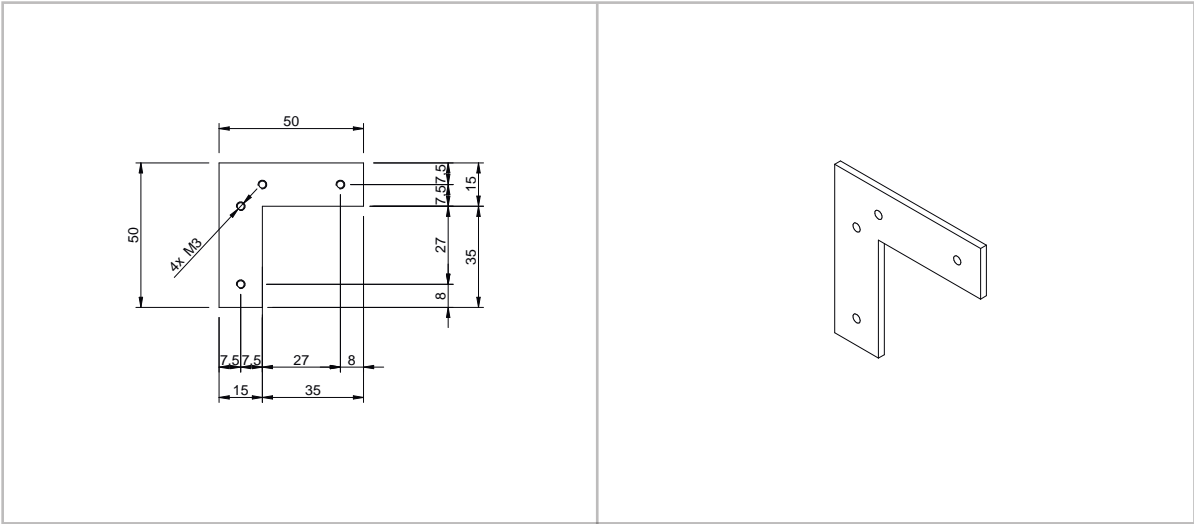

LINEAR JOINT - 5/F

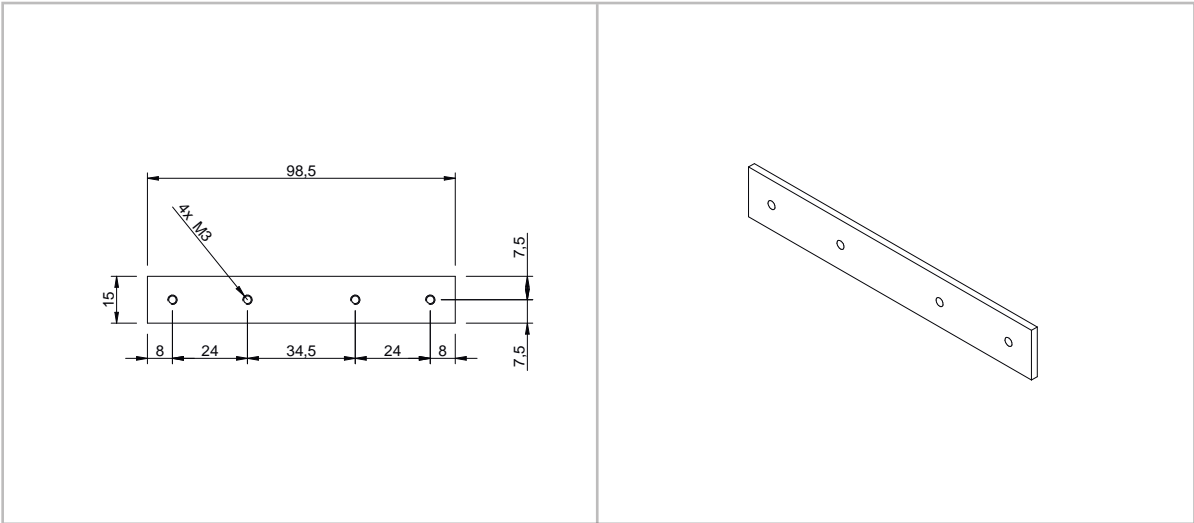

SUSPENSION ACCESSORY - 6/F

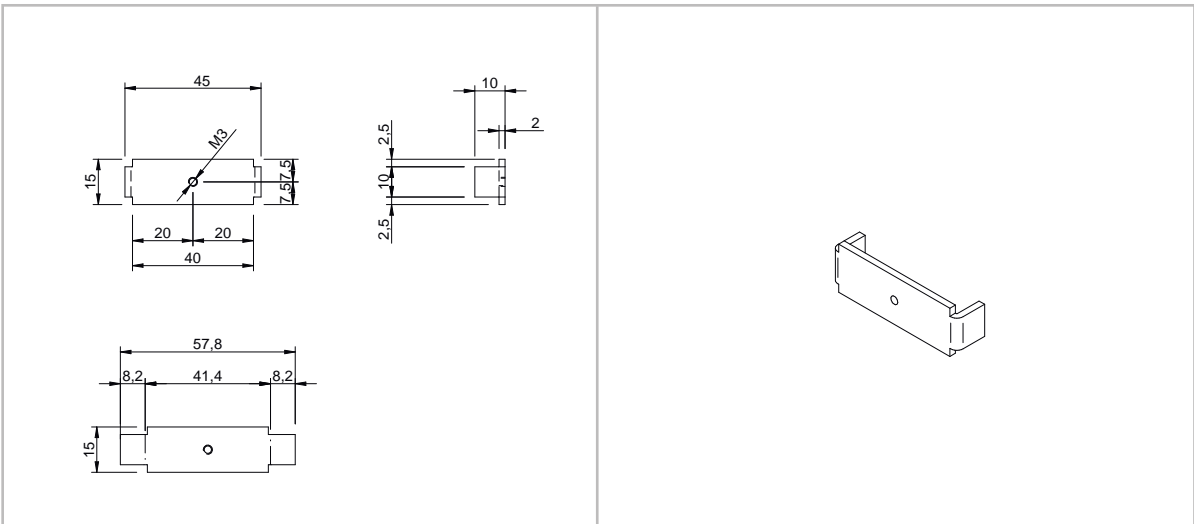





## **PROMANI SRL**

HEAD OFFICE

Via Emilia 37 - 35043 Monselice, Italy

REGISTERED OFFICE

Largo Tommaso Gallarati Scotti 1 - 20123 Milan, Italy

VAT n°: 10300080966

Tel. +39 (0) 429 1905828

[info@pro-mani.com](mailto:info@pro-mani.com)

**[www.pro-mani.com](http://www.pro-mani.com)**